

## P12A

Multifaster 12 lines

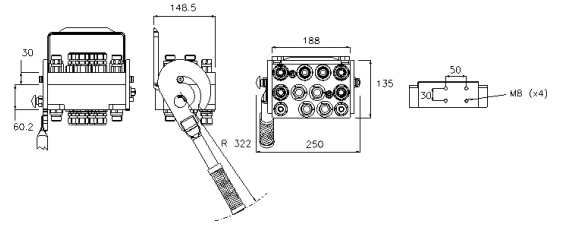

### Applications



Seals	<b>NBR &amp; PUR</b>
Material	<b>Aluminium &amp; Stainless Steel &amp; Steel</b>
Valve Type	<b>Flat</b>
Working temperatures	<b>-25 °C to 100 °C</b>
Surface treatment	<b>MATE 500 (CrIII) &amp; Paint</b>
Series Interchange	<b>MULTIFASTER</b>
Connection	<b>Lever</b>
Disconnection	<b>Lever</b>
Connection Under Pressure	<b>Allowed Residual</b>